



**Siam Bayview Hotel**  
PATTAYA

**SIAM BAYVIEW HOTEL | PATTAYA**



Perfectly Positioned in the Centre of Pattaya

## Perfectly Positioned in the Centre of Pattaya

### LOCATION

In the heartbeat of Pattaya's shopping and entertainment on the beachside promenade facing Pattaya Bay. Attentively designed, with a fresh, contemporary look and a laid-back atmosphere constructed around a free-flowing open-air lobby. The ambience is friendly and the facilities are secluded for quiet relaxation.

### AIRPORT DIRECTIONS

The Siam Bayview is a convenient 90-minute drive southeast of Bangkok's Suvarnabhumi Airport, 140 kms. away.

### GUEST ACCOMMODATION

Guest rooms in the Bayview Tower offer a choice of ocean views or panoramic cityscapes with a mountain backdrop. All suites contain living and dining areas and sweeping vistas of the ocean. Garden Wing rooms overlook the pristine pool and landscaped gardens.

### ROOM TYPES

**Total: 260 rooms and suites**

#### Bayview Tower (159 rooms & 14 suites)

Deluxe Sea View	76
Deluxe Mountain View	83
Deluxe Suite	3
Siam Suite	5
Bayview Suite	6

#### Garden Wing (87 rooms)

Deluxe Garden Wing	87
--------------------	----

### GUEST ROOM FACILITIES

- Wired & Wi-Fi internet access
- LCD/flat screen TV with satellite and cable channels (PTP, CNN, DW, TV5, NHK, etc.)
- Electronic key-lock on doors
- In-room coffee and tea
- Electronic personal safe
- Individually controlled air-conditioning
- Complimentary bottled water (2)
- Private bath and shower
- Mini-bar/refrigerator
- IDD telephone
- Radio/CD player
- Private balcony (Tower Wing)
- Cotton bathrobes & slippers
- Hairdryer
- Complimentary bathroom amenities
- Electricity: 220 volts (transformers available)

Non-smoking rooms, wheelchair accessible rooms & inter-connecting rooms available.







## HOTEL SERVICES

- 2 Outdoor pools with Jacuzzi
- 24-hour in-room dining
- Daily housekeeping
- Laundry & dry cleaning service
- 24-hour doctor on call
- Business centre
- Broadband internet in public areas
- Thai & aromatherapy massage services
- Fitness room
- Babysitting & cribs
- Tour, travel & car rental desk
- Major credit cards accepted
- Banks & ATMs nearby
- Safe deposit boxes







## MASSAGE PAVILIONS

Two pavilions are conveniently situated around the pools. Guests have the choice of the air-conditioned Thai style pavilion by the Garden Pool or the open-air canopied pavilion next to the Tower Pool. Uniquely designed Thai and aromatherapy treatments are delivered by professional certified therapists for overall well-being.

## RECREATION & SPORTS

- 2 outdoor pools with Jacuzzi
- 2 floodlit tennis courts
- Fitness room
- Table tennis & darts
- Pool table & board games
- Boat launch nearby
- Water sports nearby: parasailing, water skiing, scuba diving & fishing
- 18 world-class golf courses nearby
- Horse riding, motor racing & go-carting nearby
- Charming gardens & grounds







## DINING & ENTERTAINMENT

**Garden Terrace Café** Light snacks and sumptuous Thai and international cuisine in a garden setting by the pool.

**Narissa Chinese Restaurant** On Beach Road with beautiful views of Pattaya Bay, serving superb Chinese cuisine and delicious seafood specialties.

**Narissa Garden Seafood Barbecue** Nightly BBQ featuring fresh seafood in an outdoor atmosphere facing the beach.

**Exotica Bar & Lounge** Delicious cocktails and snacks, board games, pool table, internet terminals.

**Fontainebleau Lounge** Relaxed and breezy open-air lobby bar with live entertainment.

**Pool Bars** Snacks, salads and cool drinks served daily poolside.

## AREA ATTRACTIONS

*Unless noted, attractions are 15-25 minutes away by car.*

- ❖ Central Festival Shopping Mall (just next door)
- ❖ Royal Garden Plaza & Mike Shopping Mall (10 mins. walk)
- ❖ Factory Outlet Mall
- ❖ Jomtien Beach
- ❖ Nong Nooch Village - cultural shows, elephants, zoo, orchid garden
- ❖ Pattaya Elephant Village
- ❖ Mini Siam - historical monuments in miniature sizes
- ❖ Ripley's Believe It Or Not Museum
- ❖ Pattaya Crocodile Farm
- ❖ Wat Yannasangwararam Temple
- ❖ Underwater World
- ❖ The Sanctuary of Truth (Prasart Satchatham)
- ❖ Alcazar & Tiffany cabaret shows
- ❖ Alangkarn variety show
- ❖ Coral Island (Koh Lan) - 45 mins. by boat
- ❖ Khao Kheow Open Zoo - 45 mins. by car
- ❖ Sriracha Tiger Zoo - 45 mins. by car
- ❖ Samet Island in Rayong Province - 1 hr. by car, plus short boat ride

## ENVIRONMENTAL STANDARDS & PRACTICES

A winner of Asean Green Hotel Award 2008, the Siam Bayview Hotel adopts the high environmental standards of the Green Leaf Foundation and undergoes annual auditing to ensure the quality of its green practices. Consistently recognized for achieving the highest levels of environmental conservation, we are firmly committed to preserving Thailand's environment.

## FIRE SAFETY

Fire safety codes and standards are diligently maintained at the Siam Bayview Hotel. Fire prevention and safety training and exercises are conducted on a regular basis. The hotel is certified by The Department of Protection and Welfare for meeting and exceeding all legal codes and requirements of the "National Fire Prevention and Safety Laws."





## MEETING FACILITIES & SERVICES

- 4 meeting rooms accommodating 20 to 200 guests
- Atlantis Room provides sweeping views of the gardens
- Poseidon Room for exclusivity
- Elegant venues for indoor or outdoor receptions
- Poolside parties and barbecues
- Local and international cuisine and decor presentations

## EVENT SERVICES

- Dedicated personal events coordinators
- Theme parties & barbecues poolside or in the gardens
- Creative fun-filled entertainment choices
- Lively breakfasts, buffets & gala dinners
- Themed coffee breaks
- Meeting breaks with Thai massage
- Chinese themed banquets
- Wedding planning services



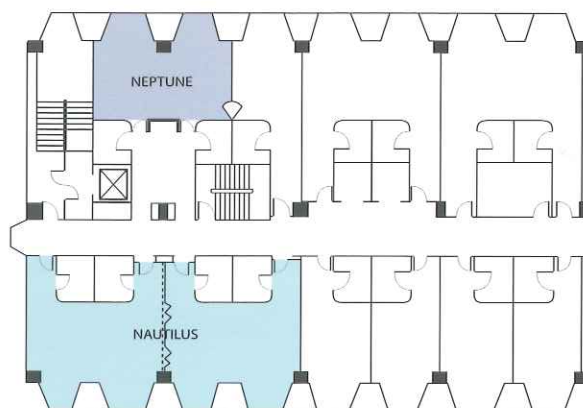
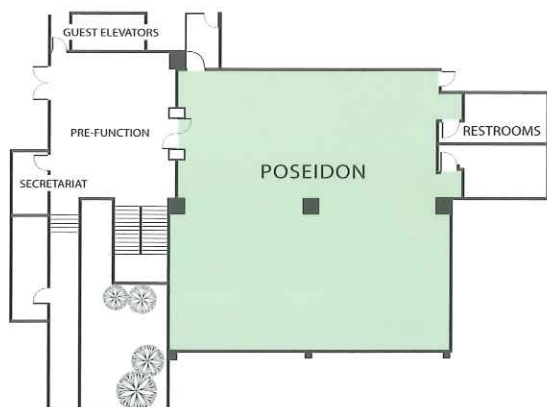
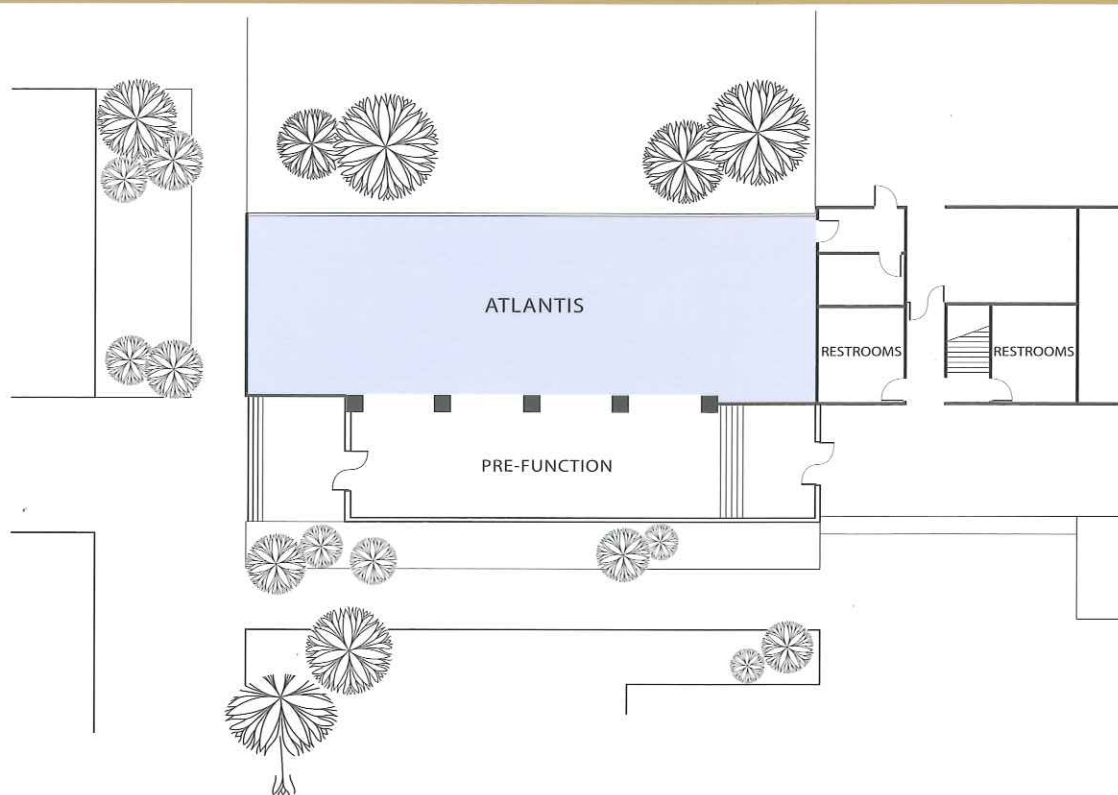

VENUES	DIMENSIONS			CAPACITIES			
	sq. m.	sq. ft.	Ceiling Height (m.)	Theatre	Classroom	Cocktail	Banquet
Atlantis	170	1829	3.20	150	100	200	100
Poseidon	210	2152	3.00	100	50	190	80
Nautilus	64	688	2.30	40	30	40	-
Neptune	45	484	2.30	30	20	-	-



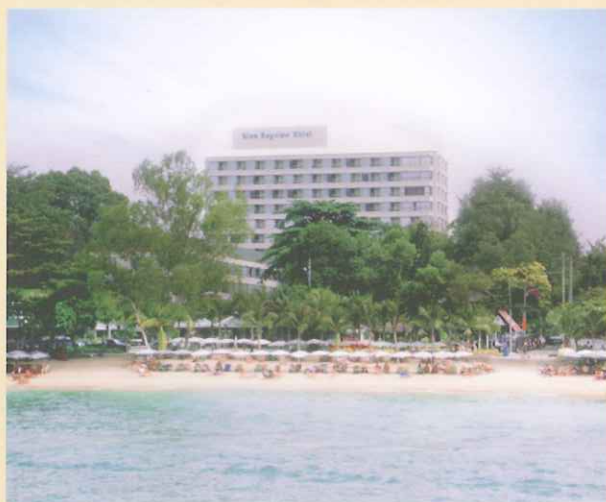

## SALES & RESERVATIONS

### PATTAYA

Siam Bayview Hotel  
310/2 Beach Road, Pattaya City  
Cholburi 20150, Thailand  
Tel. +66 38 423871-7  
Fax. + 66 38 423879  
E-mail: siambayview@siamhotels.com

### BANGKOK

Siam City Hotels & Resorts  
477 Si Ayuthaya Road, Phyathai  
Bangkok 10400, Thailand  
Tel. +66 2247-0123  
Fax. +66 2247-0165  
E-mail: sales@siamhotels.com

### BANGKOK RESERVATIONS OFFICE

Tel. +66 2247-0174, Fax. +66 2642-7948  
E-mail: reservations@siamhotels.com

### GDS ACCESS CODES

Amadeus	WV PYXBVH
Galileo	WV 73361
Sabre	WV 39959
Worldspan	WV 6411

### WEBSITE

[www.siamhotels.com](http://www.siamhotels.com)



Member of  
Green Leaf Hotels



**Siam Bayview Hotel**  
PATTAYA



ASEAN Green  
Hotel Award



Thailand Tourism  
Award 2008

310/2 Beach Road, Pattaya, Cholburi 20150, Thailand  
Tel. +66 38 423871-7, Fax. +66 38 423879, E-mail: siambayview@siamhotels.com

**A member of Siam City Hotels & Resorts**

The Siam City Hotel, Bangkok • Siam Bayshore Resort & Spa, Pattaya • Siam Bayview Hotel, Pattaya

[www.siamhotels.com](http://www.siamhotels.com)





SIAM BAYVIEW HOTEL  
Pattaya, Thailand  
Beachfront boutique  
living in down-town Pattaya

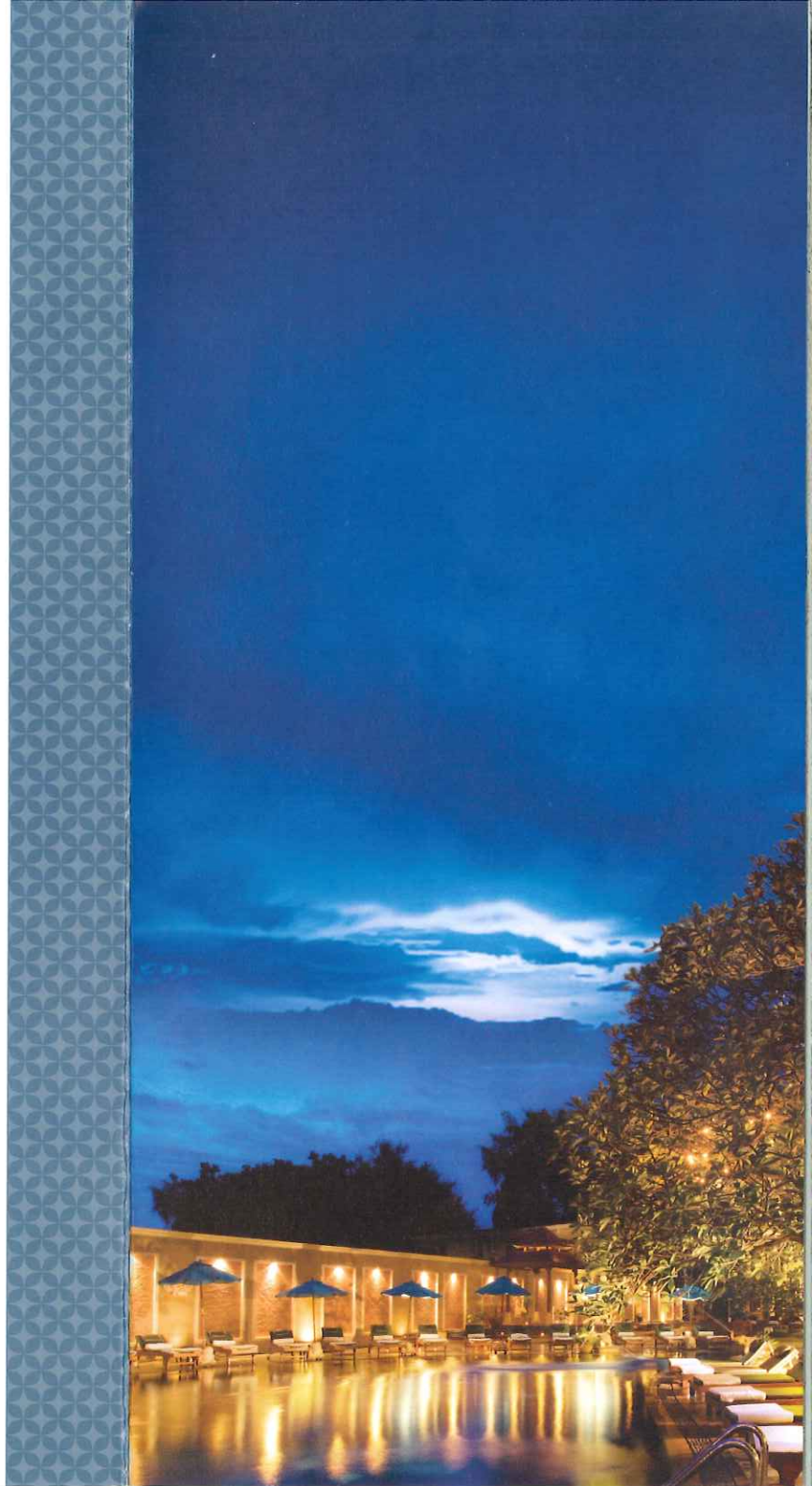

## Accommodation



Enjoy breathtaking  
panoramic ocean  
views

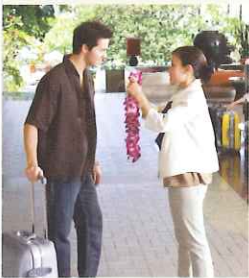

A world of stylish and artistic  
comfort awaits you in our  
sumptuous, well-appointed and  
spacious rooms with Thai and  
contemporary design influences.

All Siam Bayview Hotel rooms  
have a fantastic, world-class  
vista: choose from an ocean,  
cityscape, mountain, pool or  
garden view.

## Cuisine



Day or night, casual  
or formal, we've got  
you covered!

A unique selection of  
restaurants offers a range of  
international mouth-watering  
cuisines including Thai,  
international, Chinese and, of  
course, seafood.

Meanwhile, the Exotica Bar &  
Lounge, Fontainebleau  
Lounge and pool bars are the  
perfect spot for an intimate  
sunset aperitif in the sea  
breeze.





## Relax



Live it up or lie low...

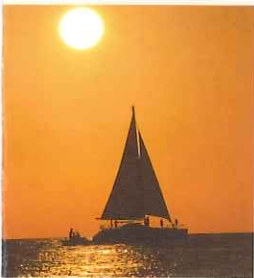

In Pattaya anything is possible. From dawn to dusk you'll have no problem filling your day. For those keen on R&R, the hotel offers tranquil surrounds, pampering and leisure pursuits.

At the Siam Bayview Hotel guests have access to two outdoor pools with Jacuzzi, two tennis courts, a fitness centre and massage pavilion, darts, pool, board games and table tennis.



## Shopping



Shop till you drop  
in Thailand's  
fashion capital

Shopping is a major pastime in Thailand, and Pattaya is no exception. Incredible shopping, both budget and high-end, is available non-stop both day and night just a few steps from the hotel.

Next door to the hotel is located the all-new Central Festival shopping mall, incorporating more than 200 fashion outlets, countless restaurants, a cinema, bowling alley and more!







Pattaya is a dynamic getaway to Thailand's Eastern Seaboard. Offering a lifestyle both refreshing and exhilarating, that has for years attracted an eclectic mix of visitors.

Steps away from Pattaya Beach, the boutique Siam Bayview Hotel fuses together a relaxing tropical seaside holiday and vibrant city life.

Besides water sports, Pattaya is peppered with open-air cafes, bars, bazaars, shopping malls, entertainment complexes, cultural sites and cabaret theatres.



The Siam Bayview Hotel offers a welcome and casual break in the city that never sleeps...

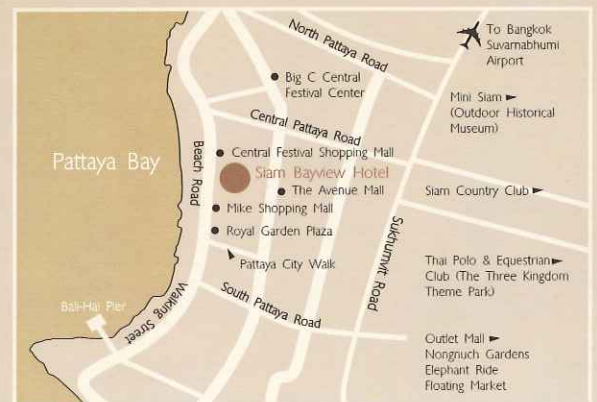

  
**Siam Bayview Hotel**  
 PATTAYA

310/2 Beach Road, Pattaya Cholburi, 20150, Thailand  
 Tel: +66 (0) 3842 3871-7 Fax: +66 (0) 3842 3879  
 E-mail: [siambayview@siamhotels.com](mailto:siambayview@siamhotels.com)  
[www.siamhotels.com](http://www.siamhotels.com)